

624.074.5

—

1-480

• • • , • • • ,
• • • • , • • • •

« »

• 10,4 . ²

50-70
30-50%.

30% [1].

30-50

[2].

1-480

0,1 - 0,2
0,2 – 0.4

[4].

1-480

14

1 2.

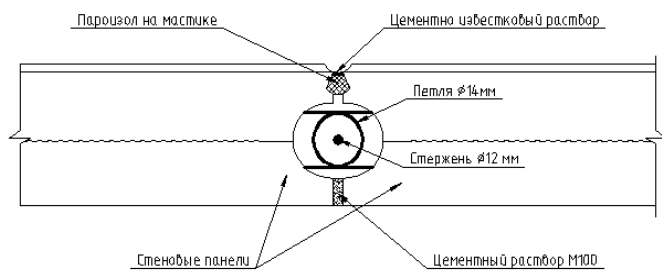

.1.

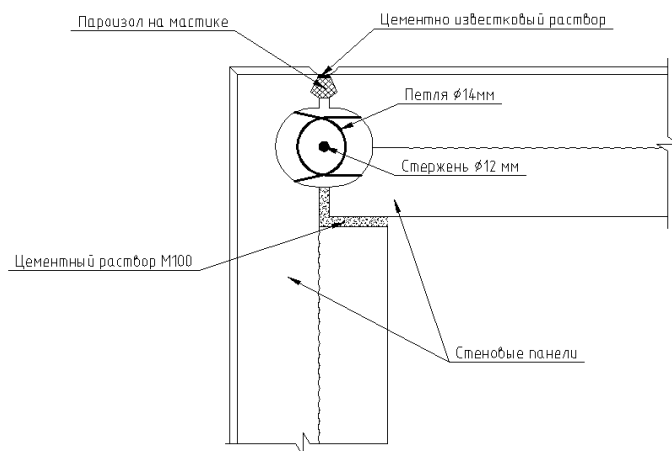

.2.

1-480 (

)

1-480 SCAD Office

11.3.

30-50-70%,

30% "5".

5-

SCAD Office 11.3

200.

1-480 . 3.

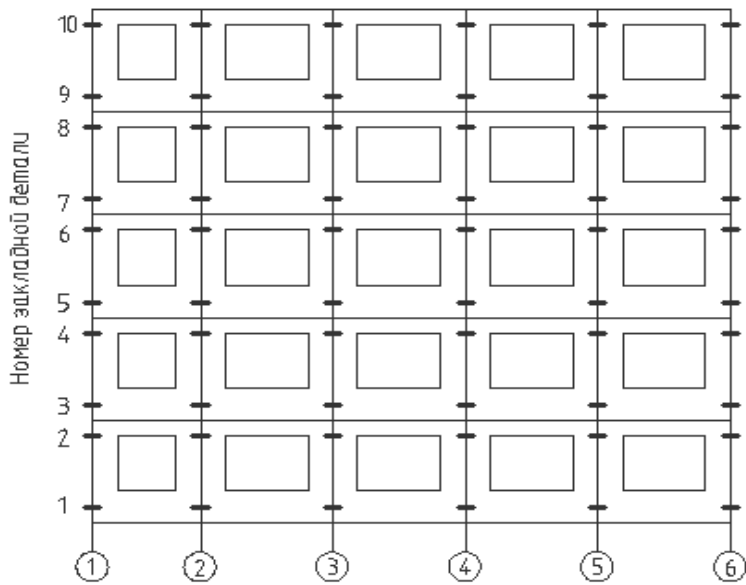

3. 1-480 .

. 4.

30%.

8

,

.

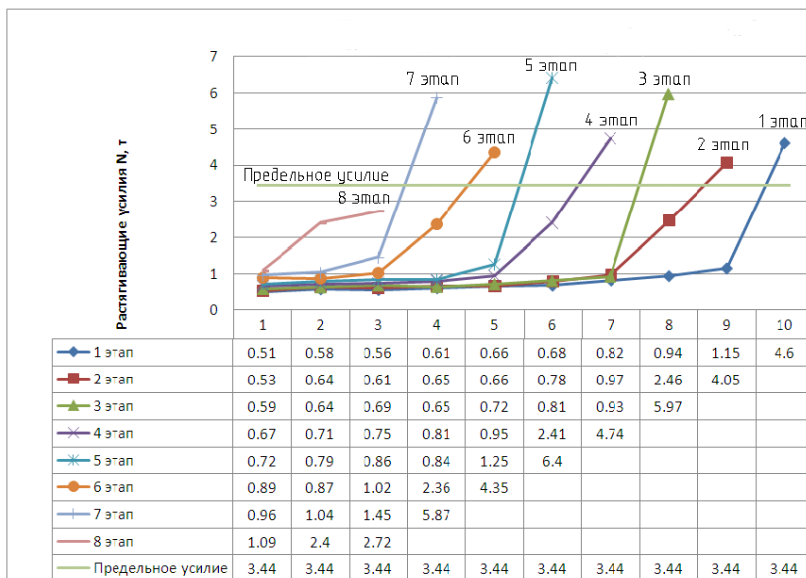

.4

30%.

1

5-

,

2

. 3

7

8

,

2-

2.72 .,

3.44 .

50%,

200,

-

6

-

1

5-

, 2

5-

,

4- . 3,4 5 2 . 5 -

50%. 1.01 , 1.75 . -

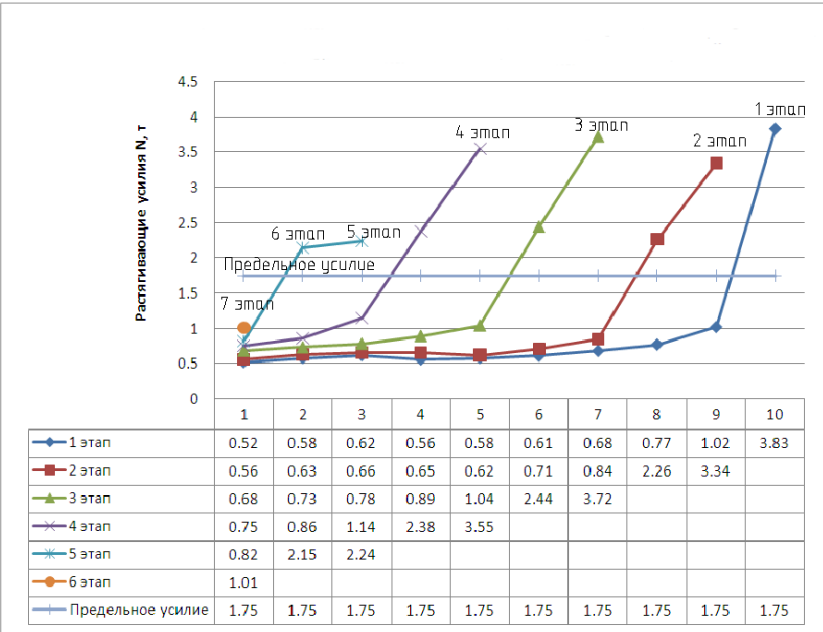

.5 50%. -

70%, 1 -
5- , 2 7 6 ,
4- , 3- . 3 4 2 -
0.51 , -
0.63 . -
. 6 -
70%. -

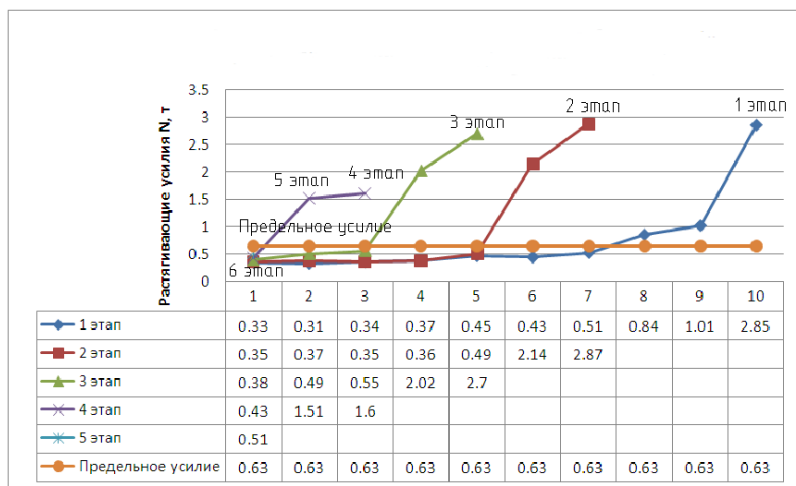

.6.

70%

1.

30, 50, 70 %.

2.

30 %,

50 70%,

1.

, 1970.- 215 .

2.

, 1988.- 223 .

3.

, 1980.-192 .

4.

, 1980.-336 :